

RM16AC(M)8000

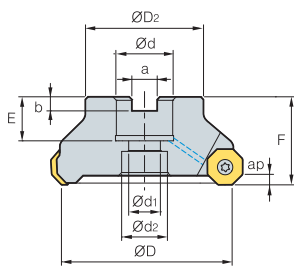

Fig. 1

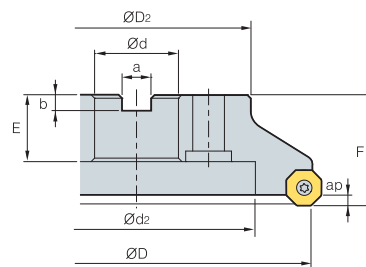



Fig. 2



AA
45°

- AR: -6°
- RR: -6°

(mm)

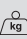
Designation		ØD	ØD2	Ød	Ød1	Ød2	a	b	E	F	ap		Fig.
RM16ACM 8063HR-M	5	63	49	22	11	18	10.4	6.3	20	40	5.5	0.7	1
RM16AC 8080HR-M	6	80	57	25.4 (27)	14	20	9.5 (12.4)	6 (7)	25 (23)	50	5.5	1.2	1
(RM16ACM) 8100HR-M	7	100	67	31.75 (32)	18	26	12.7 (14.4)	8	33 (25)	63 (50)	5.5	1.8	1
8125HR-M	8	125	87	38.1 (40)	22	32	15.9 (16.4)	10 (9)	35 (29)	63	5.5	3.5	1
8160R-M	10	160	107	50.8 (40)	-	107	19 (16.4)	11 (9)	38 (32)	63	5.5	4.5	2
8200R-M	12	200	130	47.625 (60)	-	135	25.4 (25.7)	14 (14)	38 (32)	63	5.5	5.8	2
8250R-M	14	250	180	47.625 (60)	-	180	25.4 (25.7)	14	38	63	5.5	11.4	2
8315R-M	18	315	240	47.625 (60)	-	238	25.4 (25.7)	14	38	63	5.5	18.8	2
8400R-M	24	400	260	47.625 (60)	-	238	25.4 (25.7)	14	38	80	5.5	32.7	2

() Metric size

Available inserts

ONHX-MF	ONHX-ML	ONHX-MM	ONHX-W	ONHX-MA	ONMX-MF	ONMX-MM
						

Designation	Cermet		Coated										Uncoated			page			
	CN2000	CN30	NCM325	NC530	NCM535	NCM545	PC2505	PC2010	PC3600	PC3700	PC8510	PC9530	PC9540	PC5300	PC5400		ST30A	G10	H01
ONHX 080608-MM											●			●	●				E14
080608-MF											●			●	●				
080608-ML														●	●				
080608-MA																		●	
080608-W											●			●	●				
0806ANN-MM											●			●	●				
0806ANN-MF											●			●	●				
ONMX 080608-MM					●			●	●	●	●			●	●				
080608-MF					●			●	●	●	●			●	●				
0806ANN-MM					●			●	●	●	●			●	●				
0806ANN-MF					●			●	●	●	●			●	●				

Available arbors

Designation	Available arbors	
	RM16AC	RM16ACM
RM16AC 8063HR-M	-	BT□□-FMC22-□□
(RM16ACM) 8080HR-M	BT□□-FMA25.4-□□	BT□□-FMC27-□□
8100HR-M	BT□□-FMA31.75-□□	BT□□-FMC32-□□
8125HR-M	BT□□-FMA38.1-□□	BT□□-FMB40-□□
8160R-M	BT□□-FMA50.8-□□	BT□□-FMC40-□□
8200R-M		
8250R-M		
8315R-M		
8400R-M	BT□□-FMA47.625-□□	BT□□-FMB60-□□

Parts

Specification		
Ø63-Ø400	FTGA0513	TW20-100

Available inserts E14 Available arbors and bolt E400~E402